



## Low Profile Sanitary Bulk Bag Discharger with Integrated Combo Hopper

### Application Details:

NBE CSO: E902190016

Material: Ascorbic Acid, Calcium Carbonate

Bulk Density: 38 & 25 lbs/ft<sup>3</sup>

Particle Size: Powder

Flowability: Semi to Non Free Flowing

Area Classification: General Purpose

### Application Overview:

NBE provided a sanitary bulk bag discharger with a combo hopper and u-trough agitator designed to fit into a low headroom location. The upper frame utilized NBE's low profile design along with NBE's low profile bag hanger. The unit was constructed from 316 stainless steel for product contact along with 304 stainless steel for non-product contact. A NEMA 4X watershed enclosure along with stainless steel conduit was provided to handle the washdown requirements in between product changeover. NBE also designed and provided an all stainless steel operator platform.

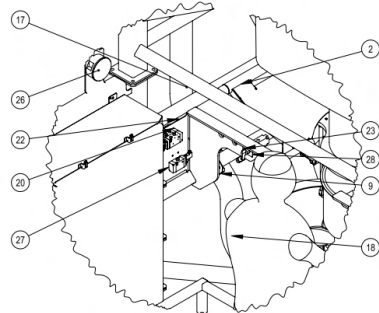
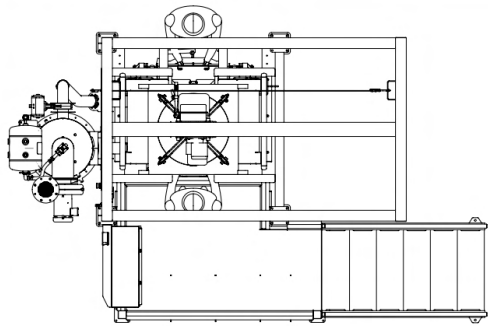

DETAIL F  
SCALE 1:11

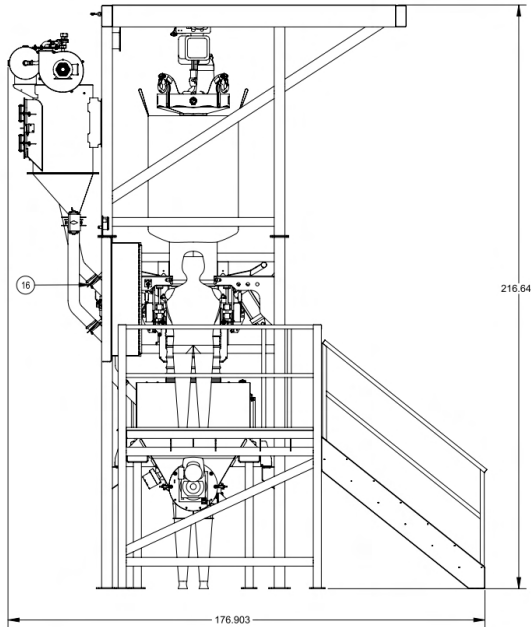

176.903

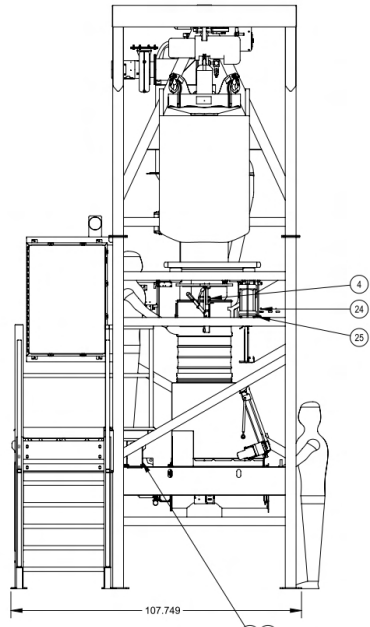

107.749

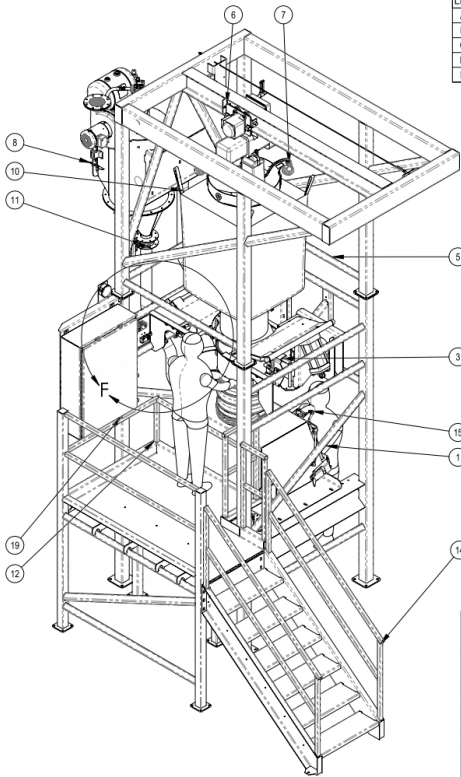

REVISIONS		NAME	DATE
LET	REVISION NOTES		
A	ISSUED FOR APPROVAL	CAR	9/10/2020
B	AS RELEASED	CAR	11/14/2020
C	REPLACED SOLENOID VALVE. SEE PNU SCHEM 04217800	CAR	11/17/2020
D	ADDED E3 COVER AND FRAME BRACES	CAR	12/17/2020
E	AS BUILT	CAR	12/22/2020

CSO #: E902090016  
JOB #: J37919

ELECTRICAL SCHEMATIC: 04800900  
PNEUMATIC SCHEMATIC: 04217800

A286764-01S - ASSYBBU 304SS/316SS

ITEM	QTY	PART NO.	DESCRIPTION
1	1	W286767-01S	WELDMENT-BASE FRAME
2	1	49A1130-01S	ASSEMBLY MASSAGE PADDLE SET 304SS
3	1	A286773-01S	ASSEMBLY E3 12" DC LEFT 316SS/304SS
4	1	W317073-01S	WELD E3 COVER 316SS
5	1	A286777-01S	ASSEMBLY BBU TOP FRAME 304 SS
6	1	91011279	Hoist, NERM020L-L-20 Harrington
7	1	49A1025-01S	ASSEM U.L.P.H. WITH FIXED PIN 304SS
8	1	A286781-01S	ASSY DUST COLLECTOR 316SS
9	2	102A181-02S1	ASSEMBLY DUST STUB 316SS
10	1	P286785-01X	DC Flex Tube
11	3	94042086	CLAMP HOSE 4.0" FLEXTUBE BRIDGE, #0200400FT
12	1	W286786-01S	WELDMENT PLATFORM 304SS
13	2	REFERENCE	OPERATOR HUMAN MODEL
14	1	W309427-01S	WELDMENT-STAIRS 304SS
15	1	A286795-01S	ASSEMBLY BAG BREAK HOPPER 316SS
16	1	P286785-02X	DC FLEX TUBE
17	1	P286785-03X	DC FLEX TUBE
18	1	P286785-04X	DC FLEX TUBE
19	1	REFERENCE	A-42H3010SSLP Hoffman NEMA 4X
20	2	REFERENCE	Valve, Air, B5E2BB549C PH 24VDC DIN
21	1	REFERENCE	REGULATOR & BRACKET MOUNTING ASSY
22	1	REFERENCE	(83007348) VALVE, AIR, B552BB549C 24VDC
23	1	REFERENCE	Valve, Air, Switch P2L BX592JJ 1/4"
24	1	REFERENCE	BRACKET-PH 035500400
25	1	REFERENCE	REGULATOR 035501030
26	1	93010198	PRESSURE GAUGE DWYER 2010 0.10" WC
27	1	REFERENCE	Valve, Air, B5G2BB549C (24VDC Din)
28	1	REF.	TAG E-3 RAISE/LOWER
29	1	REF.	ASSY BALL VALVE 3/8" 304SS
30	2	P317071-01S	FORMED STIFFENING BRACKET 304SS
31	2	P317071-02S	BACKING PLATE 304SS

APPROVED: PROCEED AS DRAWN	DATE
APPROVED WITH REVISIONS NOTED	DATE
NOT APPROVED: REVISE AND RESUBMIT	DATE

THIS DOCUMENT CONTAINS PROPRIETARY INFORMATION AND IS THE PROPERTY OF NATIONAL BULK EQUIPMENT, INC. THE INFORMATION HAS BEEN DETERMINED TO BE CONFIDENTIAL AND SHALL NOT BE REPRODUCED, COPIED, OR USED IN WHOLE OR IN PART FOR THE MANUFACTURE OR SALE OF ANY PART OR PRODUCT BY YOU OR ANY OTHER PARTY TO WHOM THE INFORMATION MAY BE SUPPLIED WITHOUT THE PRIOR WRITTEN CONSENT OF NATIONAL BULK EQUIPMENT, INC.

**National Bulk Equipment**  
12838 STAINLESS DR., HOLLAND, MICHIGAN 49424  
PHONE: (616) 399-2220 www.nbe-inc.com

MODEL CREATOR: CAR 10/29/20 | DWG BY: CAR | DATE: 9/10/2020  
ASSY BBU 304SS/316SS

SCALE: "ASBET" SHEET: DRAWING NUMBER: A286764  
NOTE: NOT ALL ITEMS ARE TO SCALE 1:22 8 OF 8 D

